

▶ 订购码/Drder Code

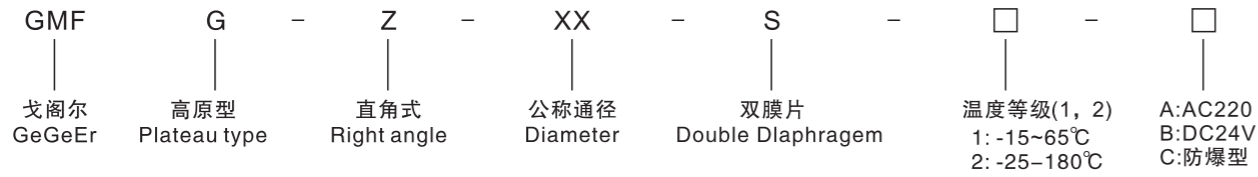

▶ 规格型号/Specifications



GMF-Z-15



GMF-Z-20



GMF-Z-25



GMF-Z-35P



GMF-Z-40S



GMF-Z-50S



GMF-Z-62S



GMF-Z-76S

▶ 产品参数/Product parameters

产品型号/Model	GMF-Z-15	GMF-Z-20	GMF-Z-25	GMF-Z-35	GMF-Z-40S	GMF-Z-50S	GMF-Z-62S	GMF-Z-76S
工作压力/Wrok pressure	0.3~0.7Mpa							
环境温度/Envionment temp[erature	-15~65℃							
相对湿度/Relative humidity	<85%							
使用介质/Use medium	干燥清洁的压缩空气/Dry clean compressed air							
电压/Electric pressure	AC110V/AC220V/DC24V							
膜片寿命/Diaphragm life	喷吹100万次以上/Injection of 1 million or more							
公称通径/Nominal diameter	Φ15	Φ20	Φ25	Φ35	Φ40	Φ50	Φ62	Φ76
连接螺纹/Connection threed	G1/2"	G3/4"	G1	G1-1/4"	G1-1/2"	G2"	G2-1/2"	G3"
流量系数Kv/Cv/The discharge coefficient	17.55/20.48	26.16/30.53	34.11/46.13	45.82/53.47	62.09/72.46	136.58/159.39	165.84/193.54	
喷吹面积(m²)/The injection area		3.5~6	8~10	10~13	12~16	18~28	27~38	37~65

▶ 外形尺寸/Dverall Dimension

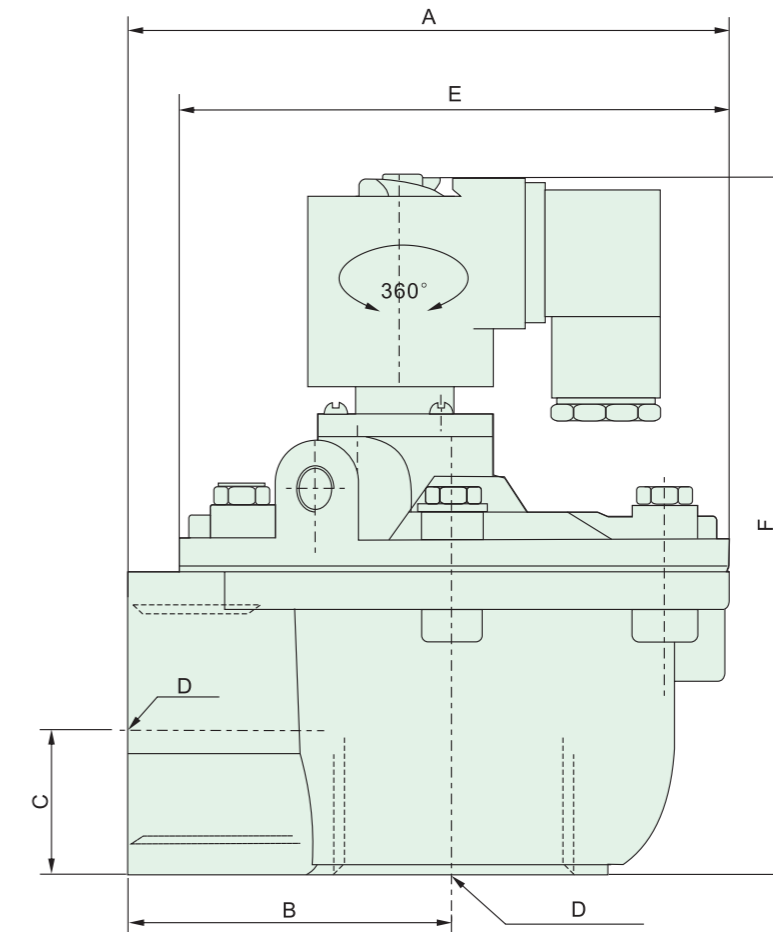

▶ 尺寸表/Dimension Sheet

符号/Symbol	A	B	C	D	E	F
规格/Specifications						
15	101	55.6	20	G1/2"	Φ93	125
20	101	55.6	20	G3/4"	Φ93	125
25	105	63.5	22.2	G1"	Φ82	126
35	121	64.5	30.5	G1-1/4"	Φ112	142
40	138	75.5	32.6	G1-1/2"	Φ125	175
50	205	113	40	G2"	Φ185	202
62	210	117.5	48	G2-1/2"	Φ185	225
76	230	130	63	G3"	Φ200	238

▶ 订购码/Drder Code

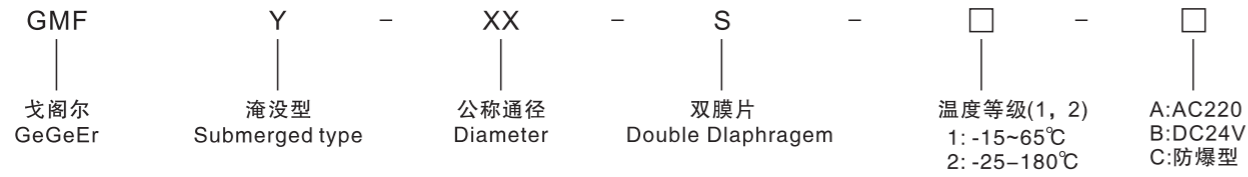

▶ 规格型号/Specifications



GMF-Y-50S



GMF-Y-62S



GMF-Y-76S



GMF-Y-89S

▶ 产品参数/Product parameters

产品型号/Model	GMF-Y-50S	GMF-Y-62S	GMF-Y-76S	GMF-Y-89S
工作压力/Wrok pressure	0.2~0.7Mpa			
环境温度/Environment temp[erature	-15~65℃			
相对湿度/Relative humidity	<85%			
使用介质/Use medium	干燥清洁的压缩空气/Dry clean compressed air			
电压/Electric pressure	AC110V/AC220V/DC24V			
膜片寿命/Diaphragm life	喷吹100万次以上/Injection of 1 million or more			
公称通径/Nominal diameter	Φ50	Φ62	Φ76	Φ89
连接螺纹/Connection threed	G2"	G2-1/2"	G3"	G3"
流量系数Kv/Cv/The discharge coefficient	62.09/72.46	136.58/159.39	165.84/193.54	175.36/203.6
喷吹面积(m²)/The injection area	18~28	27~38	37~65	40~68

▶ 外形尺寸/Dverall Dimension

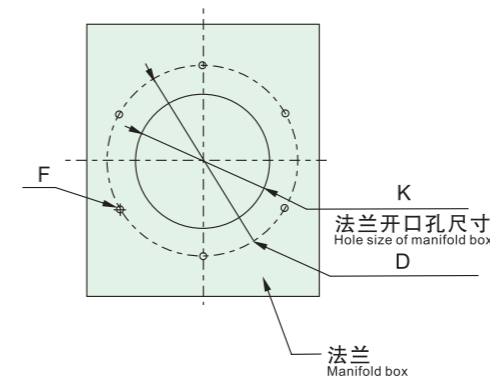
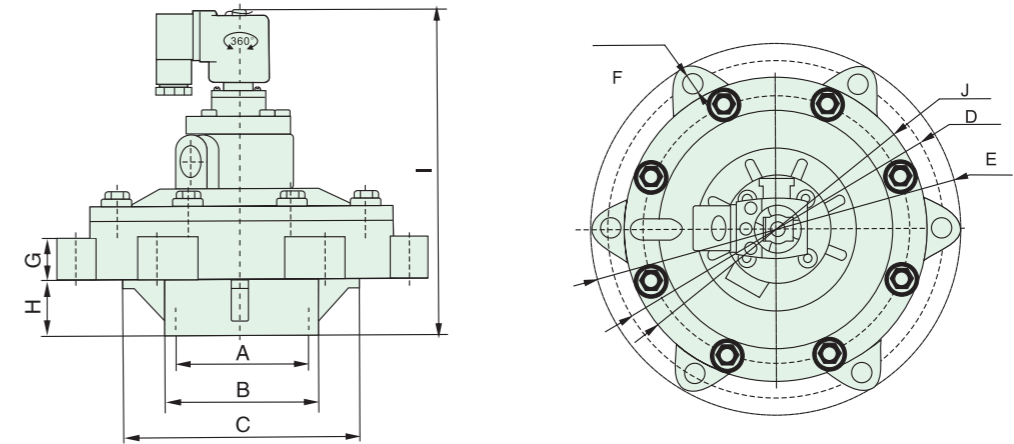

阀与法兰定位及安装孔尺寸
Locating hole size of manifold box and valve

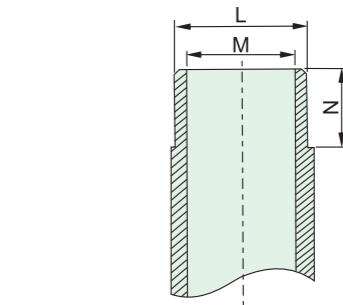

喷吹管径
Diameter for blowing tube

▶ 尺寸表/Dimension Sheet

符号/Symbol	A	B	C	D	E	F	G
规格/Specifications							
50	Φ 64.5	Φ 76.5	Φ 118	Φ 180	Φ 200	Φ 11.5	25
62	Φ 80	Φ 93.5	Φ 145	Φ 208	Φ 227	Φ 11.5	27.5
76	Φ 90	Φ 109	Φ 141	Φ 227	Φ 249	Φ 11.5	27
89	Φ 86	Φ 95	Φ 158	Φ 176	Φ 200	Φ 11	

符号/Symbol	H	I	J	K	L	M	N
规格/Specifications							
50	31	178	Φ159	Φ120	Φ61.5 ^{+0.44} _{+0.22}	Φ 50	Φ 43.5
62	35	197	Φ185	Φ145	Φ75 ^{+0.44} _{+0.22}	Φ 62	Φ 44
76	34	205	Φ200	Φ160	Φ89 ^{+0.44} _{+0.22}	Φ 76	Φ 34
89	50	190	Φ200	Φ159	Φ85 ^{+0.44} _{+0.22}	Φ 76	Φ 34

▶ 订购码/Drder Code

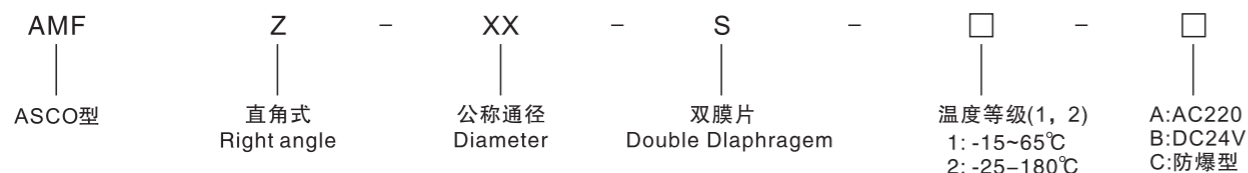

▶ 规格型号/Specifications



DMF-Z-20J (经济型) DMF-Z-25J (经济型) AMF-Z-20 SCG353A043

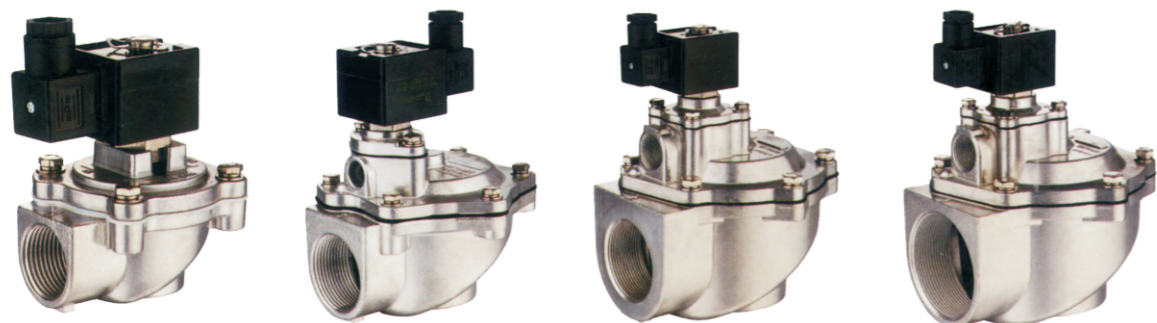

AMF-Z-25 SCG353A044 AMF-Z-40S SCG353A047 AMF-Z-50S SCG353A050 AMF-Z-62S SCG353A051

▶ 产品参数/Product parameters

产品型号/Model	DMF-Z-20J (经济型)	DMF-Z-25J (经济型)	AMF-Z-20 SCG353A043	AMF-Z-25 SCG353A044	AMF-Z-40S SCG353A047	AMF-Z-50S SCG353A050	AMF-Z-62S SCG353A051
工作压力/Wrok pressure	0.3~0.8Mpa						
环境温度/Envionment temp[erature	-15~65℃						
相对湿度/Relative humidity	<85%						
使用介质/Use medium	干燥清洁的压缩空气/Dry clean compressed air						
电压/Electric pressure	AC110V/AC220V/DC24V						
膜片寿命/Diaphragm life	喷吹100万次以上/Injection of 1 million or more						
公称通径/Nominal diameter	Φ20	Φ25	Φ20	Φ25	Φ40	Φ50	Φ62
连接螺纹/Connection threed	G3/4"	G1"	G3/4"	G1"	G1-1/2"	G 2"	G2-1/2"
流量系数Kv/Cv/The discharge coefficient	17.55/20.48	26.16/30.53	17.55/20.48	26.16/30.53	45.82/53.47	62.09/72.46	136.58/159.39
喷吹面积(m ²)/The injection area	3.5~6	8~10	3.5~6	8~10	12~16	18~28	27~38

▶ 外形尺寸/Dverall Dimension

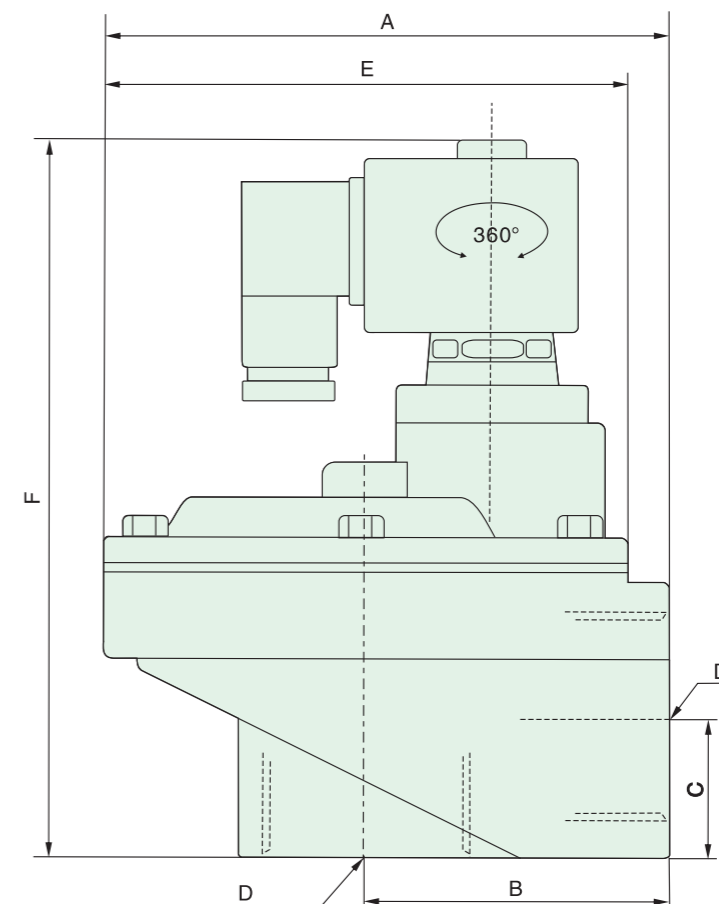

▶ 尺寸表/Dimension Sheet

符号/Symbol	A	B	C	D	E	F
规格/Specifications						
20J	89	51	21	G3/4"	75	123
25J	89	51	21	G1"	75	123
20	89	51	21	G3/4"	75	110
25	89	51	21	G1"	75	110
40	132	71	30	G1-1/2"	136	163
50	168	95	45	G2"	165	206
62	168	95	45	G2-1/2"	165	206

▶ 订购码/Drder Code

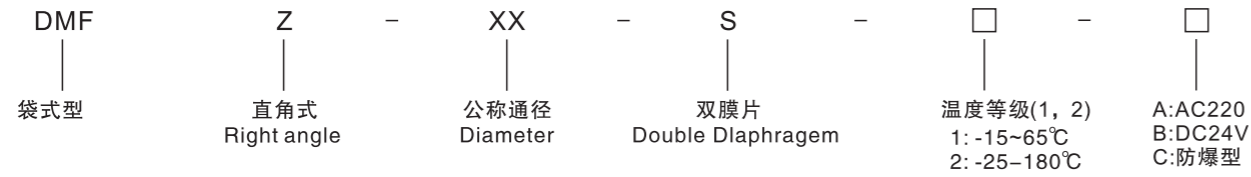

▶ 规格型号/Specifications



DMF-Z-20



DMF-Z-25



DMF-Z-40S



DMF-Z-50S



DMF-Z-62S

▶ 产品参数/Product parameters

产品型号/Model	DMF-Z-20	DMF-Z-25	DMF-Z-40S	DMF-Z-50S	DMF-Z-62S
工作压力/Wrok pressure	0.3-0.7Mpa				
环境温度/Environment temp[erature	-15-65°C				
相对湿度/Relative humidity	<85%				
使用介质/Use medium	干燥清洁的压缩空气/Dry clean compressed air				
电压/Electric pressure	AC110V/AC220V/DC24V				
膜片寿命/Diaphragm life	喷吹100万次以上/Injection of 1 million or more				
公称通径/Nominal diameter	Φ20	Φ25	Φ40	Φ50	Φ62
连接螺纹/Connection threed	G3/4"	G1"	G 1-1/2"	G 2"	G2-1/2"
流量系数Kv/Cv/The discharge coefficient	17.55/20.48	26.16/30.53	45.82/53.47	62.09/72.46	136.58/159.39
喷吹面积(m ²)/The injection area	3.5~6	8~10	12~16	18~28	27~38

▶ 外形尺寸/Dverall Dimension

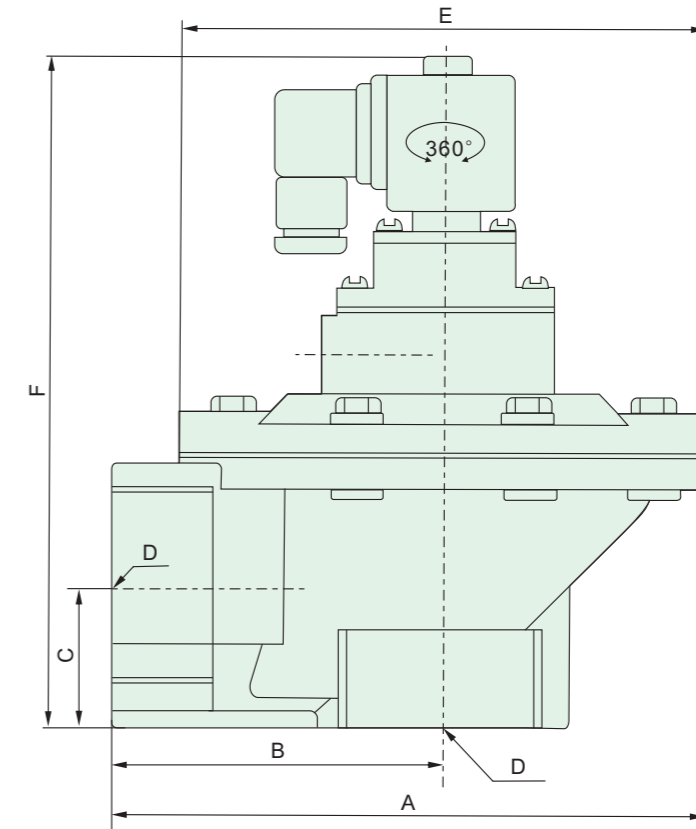

▶ 尺寸表/Dimension Sheet

符号/Symbol	A	B	C	D	E	F
规格/Specifications						
20	88	48	20	G3/4"	Φ80	128
25	108	60	23	G1"	Φ96	136
40	131	75	32	G1-1/2"	Φ112	184
50	180	100	43	G2"	Φ160	206
62	204	110	49	G2-1/2"	Φ188	226

▶ 订购码/Drder Code

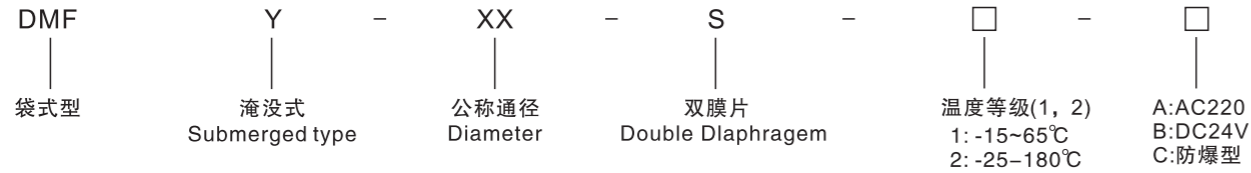

▶ 规格型号/Specifications

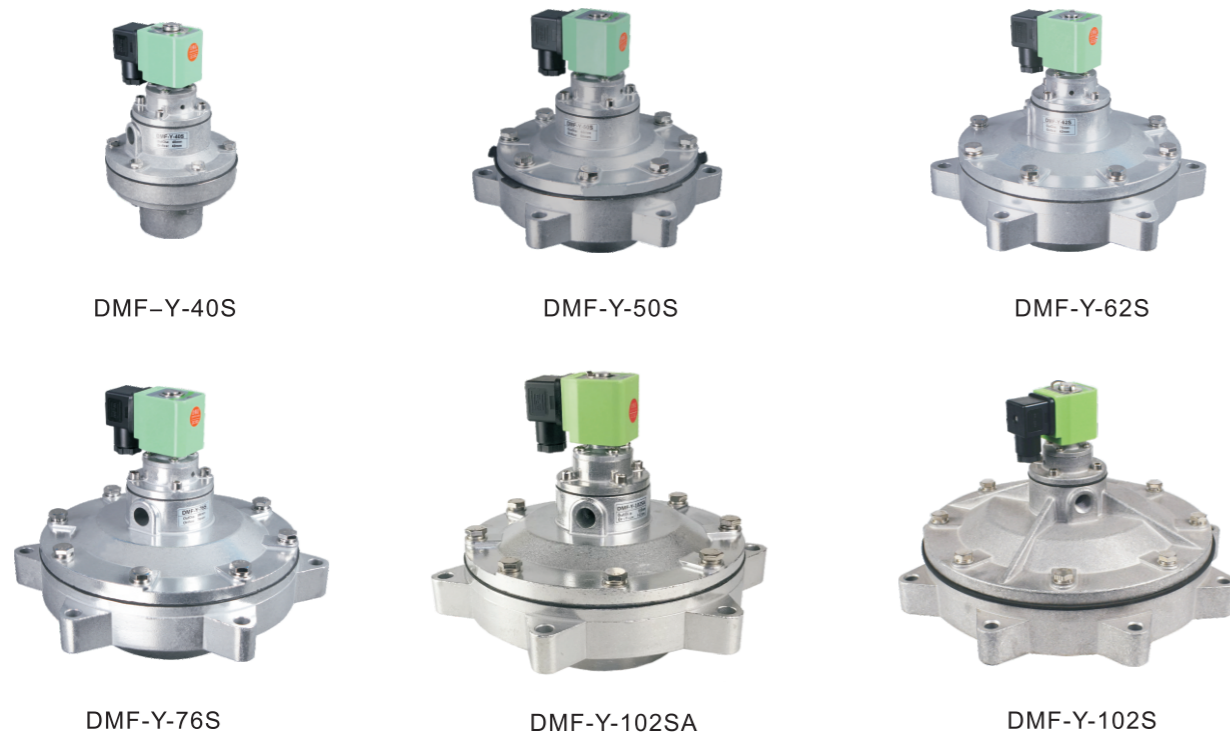

▶ 产品参数/Product parameters

产品型号/Model	DMF-Y-40S	DMF-Y-50S	DMF-Y-62S	DMF-Y-76S	DMF-Y-102SA	DMF-Y-102S
工作压力/Wrok pressure	0.3~0.7Mpa					
环境温度/Environment temp[erature	-15~65℃					
相对湿度/Relative humidity	<85%					
使用介质/Use medium	干燥清洁的压缩空气/Dry clean compressed air					
电压/Electric pressure	AC110V/AC220V/DC24V					
膜片寿命/Diaphragm life	喷吹100万次以上/Injection of 1 million or more					
公称通径/Nominal diameter	Φ40	Φ50	Φ62	Φ76	Φ102	Φ114
连接螺纹/Connection threed	G1-1/2"	G2"	G2-1/2"	G3"	G3-1/2"	G4"
流量系数Kv/Cv/The discharge coefficient	45.82/53.47	62.09/72.46	136.58/159.39	165.84/193.54	242.35/282.82	268.29/313.09
喷吹面积(m²)/The injection area	12~16	18~28	27~38	37~65	55~80	70~90

▶ 外形尺寸/Dverall Dimension

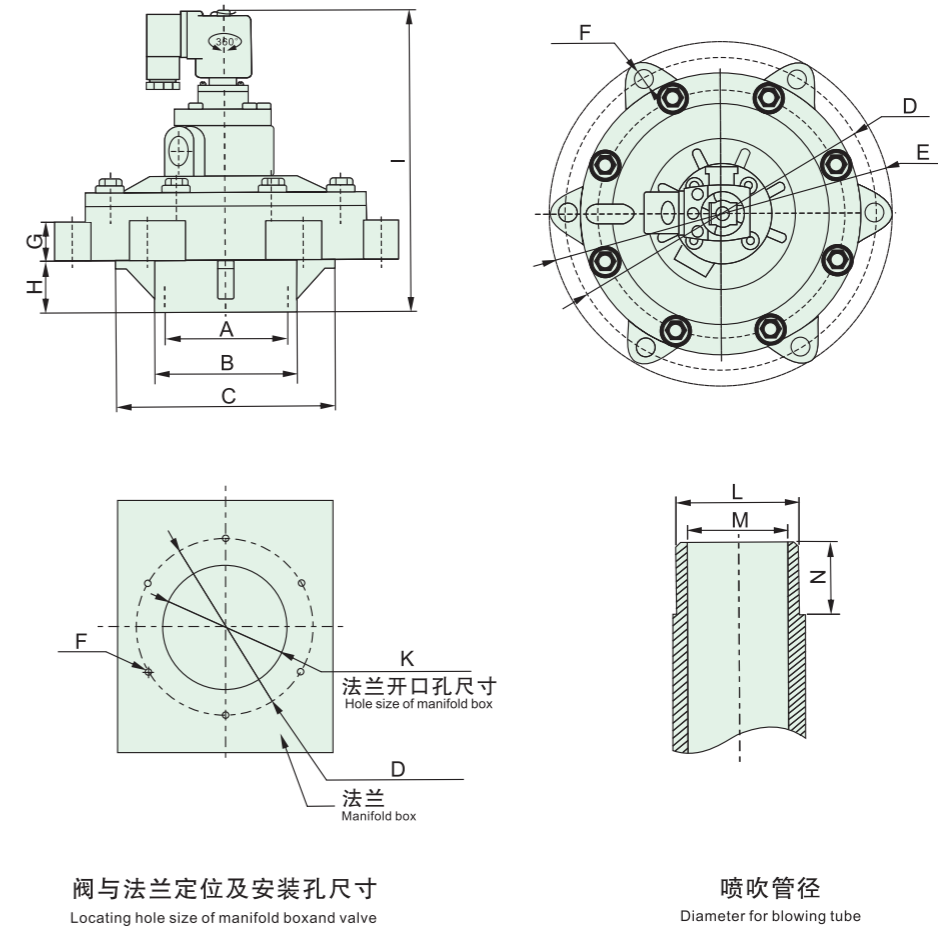

▶ 尺寸表/Dimension Sheet

规格/Specifications	符号/Symbol	A	B	C	D	E	F	G
25	G1	0	Φ67	0	Φ96	0	0	
40	G1-1/2	0	Φ76	0	Φ111	0	0	
50S	Φ60	Φ66	Φ122	Φ180	Φ202	Φ11.5	25	
62S	Φ75	Φ81	Φ147	Φ215	Φ237	Φ11.5	25	
76S	Φ87	Φ94	Φ162	Φ227	Φ249	Φ11.5	27	
102SA	Φ102	Φ108	Φ162	Φ227	Φ248	Φ11.5	32	
102S	Φ112	Φ122	Φ192	Φ280	Φ302	Φ11.5	32	

规格/Specifications	符号/Symbol	H	I	K	L	M	N
25	G1	34	-	Φ66	G1	-	
40	G1-1/2	39	-	Φ77	G1-1/2	-	
50S	Φ60	30	188	Φ124	Φ60 ^{+0.44} _{+0.22}	Φ50	
62S	Φ75	34	196	Φ150	Φ75 ^{+0.44} _{+0.22}	Φ62	
76S	Φ88	35	200	Φ160	Φ88 ^{+0.44} _{+0.22}	Φ76	
102SA	Φ101	35	210	Φ168	Φ101 ^{+0.44} _{+0.22}	Φ90	
102S	Φ113	36	240	Φ194	Φ113 ^{+0.44} _{+0.22}	Φ102	



SCXE.060

▶ 外形尺寸/Doverall Dimension

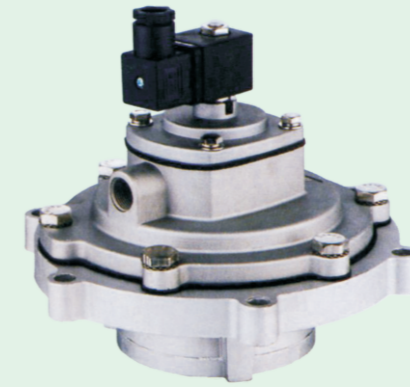
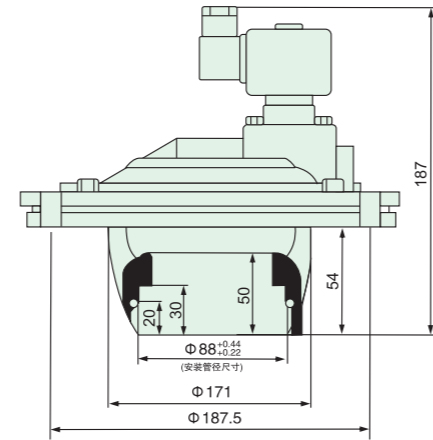

SQP-76

▶ 外形尺寸/Doverall Dimension

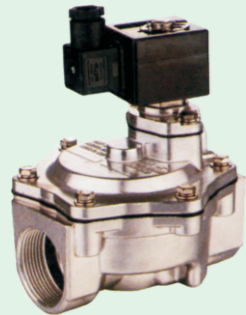
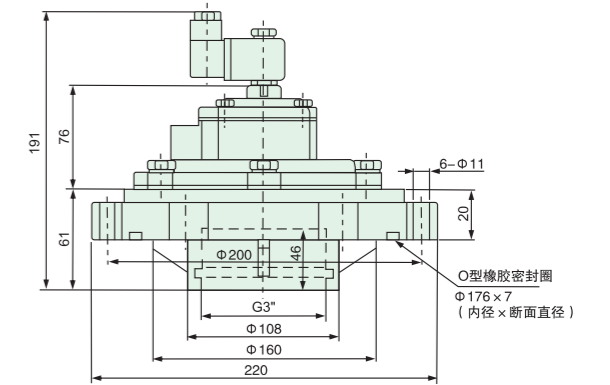

AMF-T-40S



DMF-T-62S

▶ 外形尺寸/Doverall Dimension

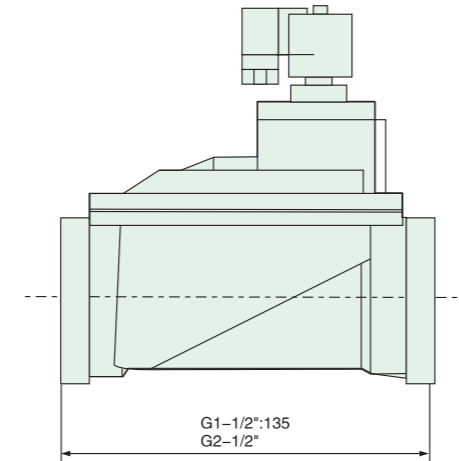

DN-80

▶ 外形尺寸/Doverall Dimension

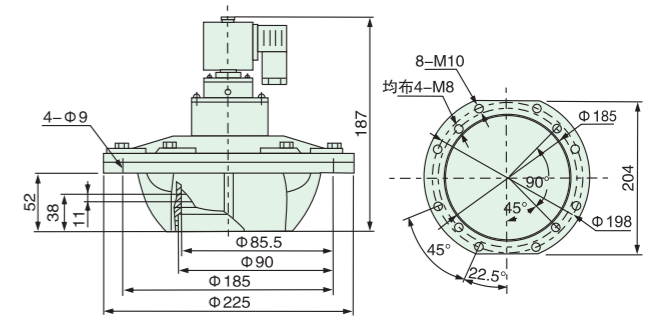

SQP-75

▶ 外形尺寸/Doverall Dimension

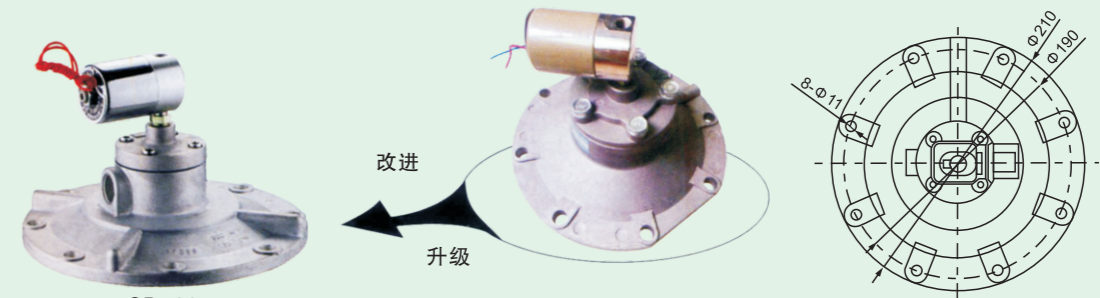
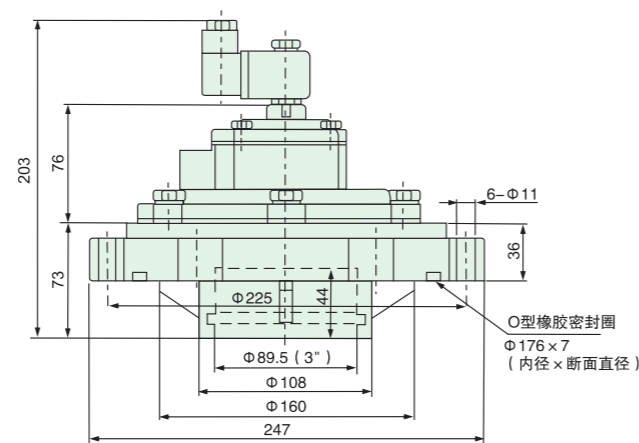

CD-80

穿壁连接器



脉冲阀配件

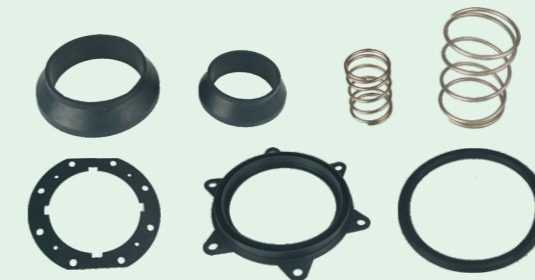

防爆线圈



▶ 高原型电磁脉冲阀膜片系列/Gao Yuan electromagnetic pulse valve diaphragm series

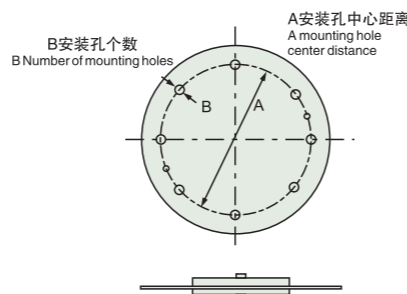
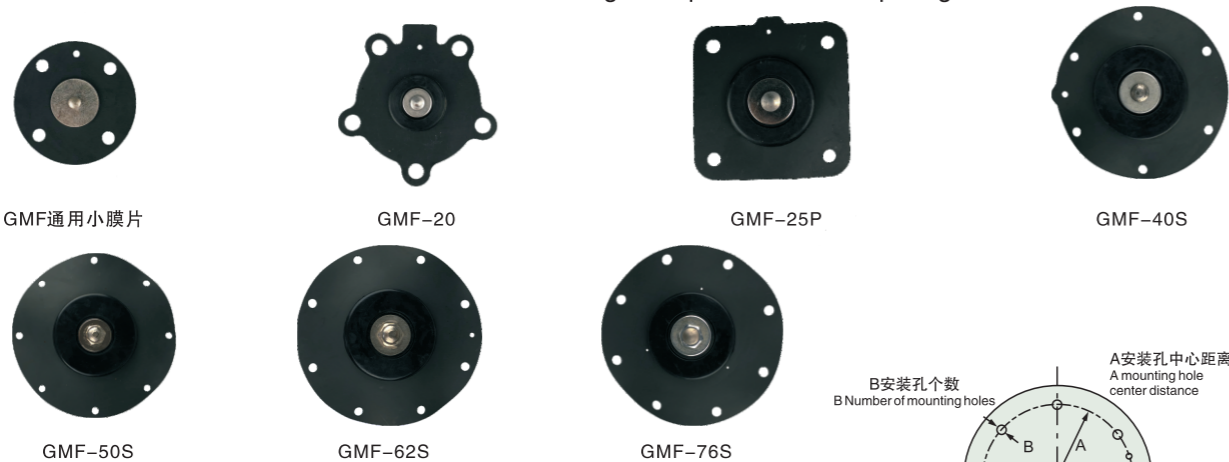

此类产品为电磁脉冲阀专用，具体性能如下：
 ○使用温度：-15℃~65℃
 ○采用优质橡胶制作
 ○工作压力达：0.3MPa~0.7MPa
 ○使用介质：清洁空气
 ○平均寿命：100万次以上
 ○密封性：在正常工作范围内，可保证无漏气现象
 ○高温膜片-20~200℃

膜片型号 Diaphragm type	A中心距(mm) A center distance	外径大约尺寸 Outside diameter approximately the size	B安装孔个数 Number of mounting holes
GMF-Z-25P	Φ85	Φ107	4
GMF-Z-35P	Φ98	Φ112	6
GMF-Z-40S	Φ112	Φ125	6
GMF-Z-50S	Φ164	Φ184	8
GMF-Z-62S	Φ164	Φ184	8
GMF-Z-76S	Φ184.5	Φ200	8
GMF-Y-50S	Φ140	Φ160	8
GMF-Y-62S	Φ164	Φ184	8
GMF-Y-76S	Φ184.5	Φ200	8
GMF-Y-89S	Φ175	Φ200	8
GMF通用小膜片	Φ52	Φ65	4

▶ 袋式型电磁脉冲阀膜片系列/Dai Shi electromagnetic pulse valve diaphragm series

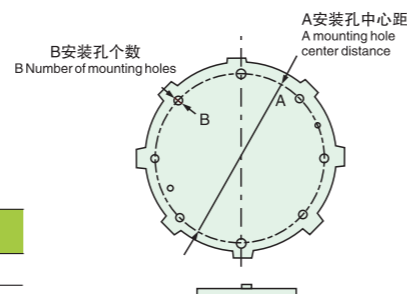
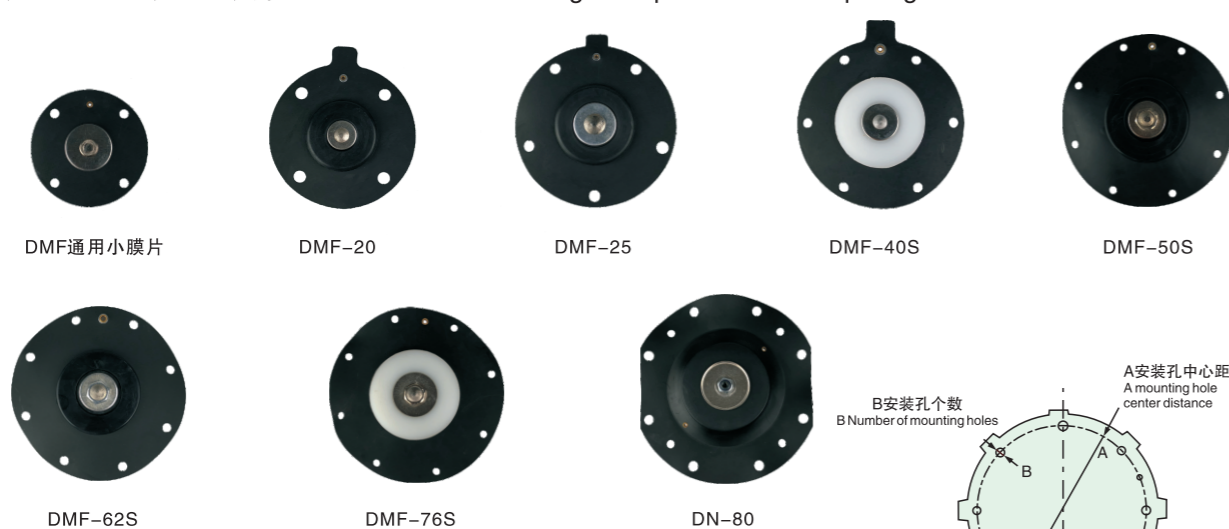

此类产品为电磁脉冲阀专用，具体性能如下：
 ○使用温度：-15℃~65℃
 ○采用优质橡胶制作
 ○工作压力达：0.3MPa~0.7MPa
 ○使用介质：清洁空气
 ○平均寿命：100万次以上
 ○密封性：在正常工作范围内，可保证无漏气现象
 ○高温膜片-20~200℃

膜片型号 Diaphragm type	A中心距(mm) A center distance	外径大约尺寸 Outside diameter approximately the size	B安装孔个数 Number of mounting holes
DMF-Z-20	Φ63	Φ80	4
DMF-Z-25	Φ83	Φ95	5
DMF-Z-40S	Φ98	Φ111	6
DMF-Z-50S	Φ142	Φ160	8
DMF-Z-62S	Φ169.5	Φ189	8
DMF-Z-76S	Φ182	Φ200	8
DMF-Y-76S	Φ182	Φ200	8
DN-80	Φ198	Φ225	8
DMF通用小膜片	Φ54	Φ66	4

▶ ACSO型电磁脉冲阀膜片系列/ASCO electromagnetic pulse valve diaphragm series

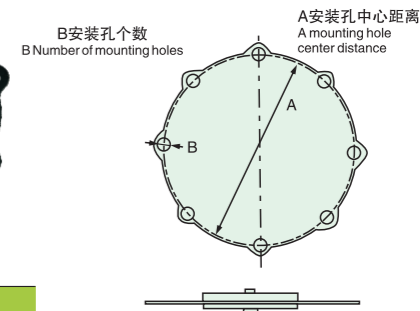

此类产品为电磁脉冲阀专用，具体性能如下：
 ○使用温度：-15℃~65℃
 ○采用优质橡胶制作
 ○工作压力达：0.3MPa~0.7MPa
 ○使用介质：清洁空气
 ○平均寿命：100万次以上
 ○密封性：在正常工作范围内，可保证无漏气现象
 ○高温膜片-20~200℃

膜片型号 Diaphragm type	A中心距(mm) A center distance	外径大约尺寸 Outside diameter approximately the size	B安装孔个数 Number of mounting holes
AMF-25	Φ78	Φ93	4
AMF-40	Φ116.5	Φ135	6
AMF-50	Φ145.5	Φ164	6
AMF-62	Φ145.5	Φ164	6
AMF-76	Φ189	Φ210	8
AMF-40小膜片	Φ47	Φ63	2
AMF通用小膜片	Φ61	Φ75	4



膜片型号 Diaphragm type	A中心距(mm) A center distance	B安装孔个数 Number of mounting holes
25托盘	Φ73	4
25碗型	Φ73	4
20A碗型	Φ90	6
MD140S		6
BD116		4
25M	Φ78	4
40M		6
50M		6
75M	Φ169	6

此类产品为电磁脉冲阀专用，具体性能如下：
 ○使用温度：-15℃~65℃
 ○采用优质橡胶制作
 ○工作压力达：0.3MPa~0.7MPa
 ○使用介质：清洁空气
 ○平均寿命：100万次以上
 ○密封性：在正常工作范围内，可保证无漏气现象
 ○高温膜片-20~200℃

▶ 在线式 on-line



▶ 型号含义/Model meaning

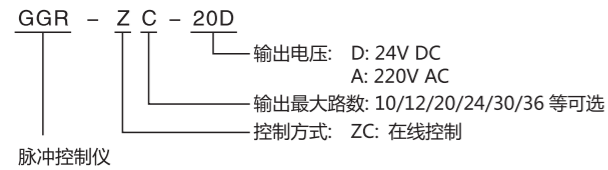

▶ 电气参数/Electrical parameters

	GGR-ZC-10D	GGR-ZC-24D	GGR-ZC-36D
输入电压	交流 220V 50Hz		
脉冲阀门数	1-10	1-24	1-36
脉冲阀电源	直流 24V, 0.8A (最大 1.0A)		
脉冲宽度	0.01-99.99秒		
脉冲间隔	1-9999秒		
周期间隔	10-99990秒		

▶ 仪器工作原理和参数/ Instrument working principle and parameter

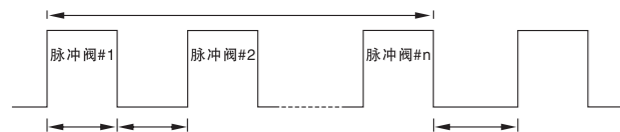

- 脉冲宽度: 每一路驱动电压的持续时间;
- 脉冲间隔: 输出两路相邻驱动电压的间隔时间;
- 输出路数: 所有脉冲阀的数量;
- 除尘周期: 控制仪完成对所有 (输出路数) 脉冲电磁阀驱动输出的时间 (该时间自动计算, 无需设置);
- 周期间隔: 两个相邻除尘周期的间隔时间;

▶ 接线图/Wiring diagram

运行控制干接点可连接压差传感器, 实现压差控制清灰, 如不使用传感器, 可将电路板上的“运行”跳线用跳线帽短接。

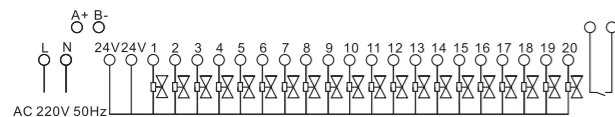

▶ 设置方案/Setup scheme



▶ 外形尺寸/Overall Dimension

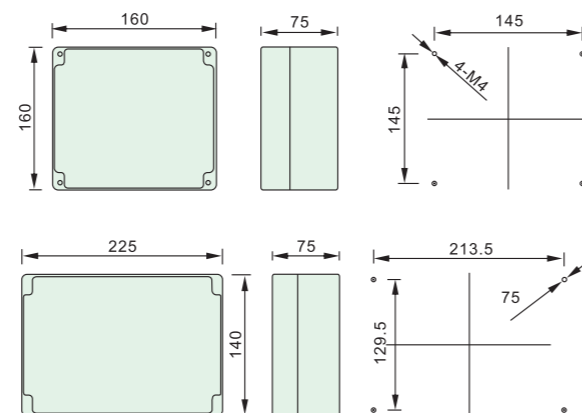

▶ 离线式 Off-line



▶ 型号含义/Model meaning

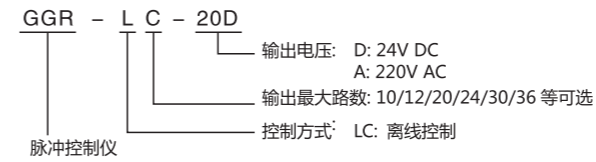

▶ 电气参数/Electrical parameters

	GGR-LC-10D	GGR-LC-240D	GGR-LC-30D
输入电压	交流 220V 50Hz		
脉冲阀电源	直流 24V, 0.8A (最大 1.0A)		
提升阀数量	0-5	0-10	0-15
每组脉冲阀数	0-10	0-20	0-30
脉冲宽度	0.01-99.99秒		
脉冲间隔	1-9999秒		
提脉间隔	1-9999秒		
室 (组) 间隔	1-9999秒		
周期间隔	10-99990秒		

▶ 仪器工作原理和参数/ Instrument working principle and parameter

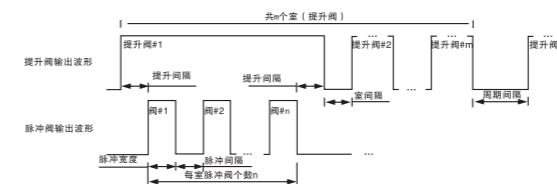

- 脉冲宽度: 每一路驱动电压的持续时间;
- 脉冲间隔: 输出两路相邻驱动电压的间隔时间;
- 提升间隔: 等待提升阀动作完成的时间 (提升间隔), 同时也是同一个室脉冲阀输出完毕后等待提升阀关闭的时间;
- 组脉冲数: 一个单元室的脉冲阀数量;
- 提升阀数: 提升阀数量, 即组数或单元室数量;
- 间隔室: 两个相邻单元室的动作间隔时间;
- 周期间隔: 所有单元室除尘完毕后到下一个除尘周期的间隔时间;

▶ 接线图/Wiring diagram

运行控制干接点可连接压差传感器, 实现压差控制清灰, 如不使用传感器, 可将电路板上的“运行”跳线用跳线帽短接。

GGR-LC-20D:

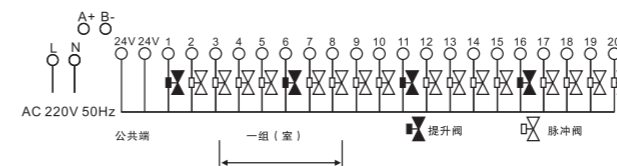

▶ 设置方案/Setup scheme



▶ 外形尺寸/Overall Dimension

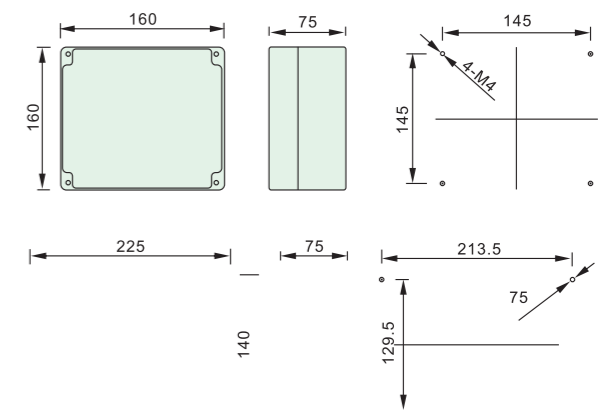

▶ 脉冲阀先导组件/Pilot assembly of pulse valve

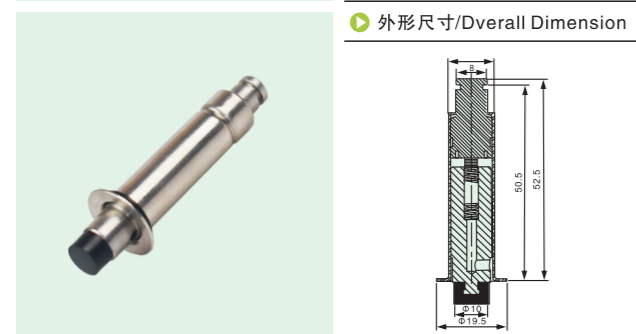
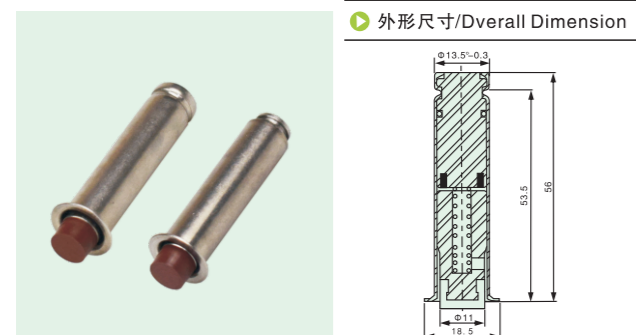
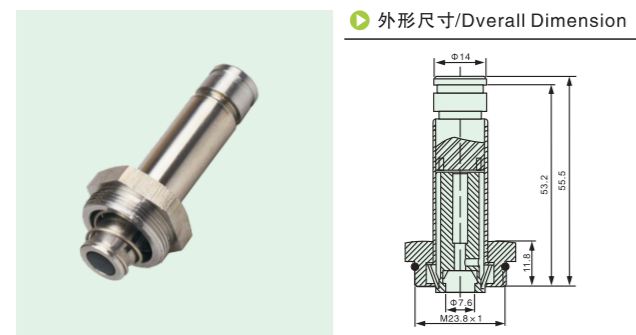
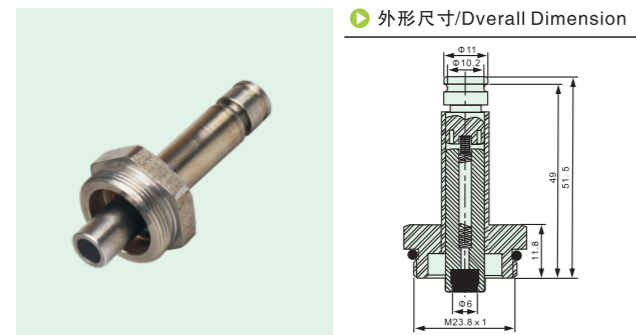
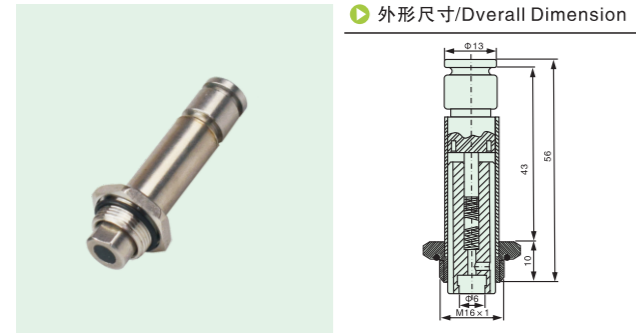

▶ 脉冲阀线圈/Pulse valve coil

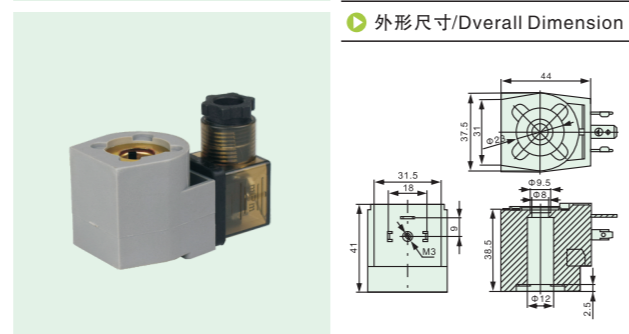
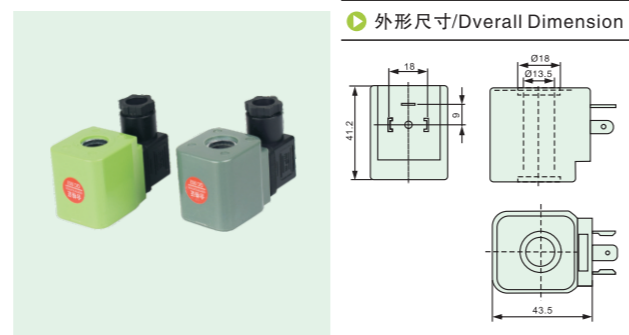
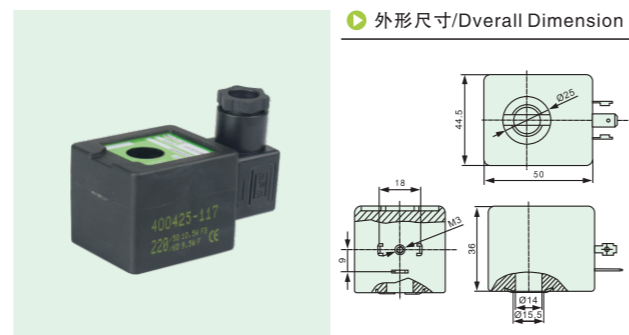
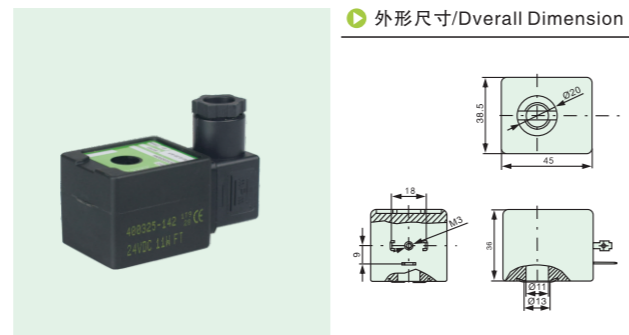
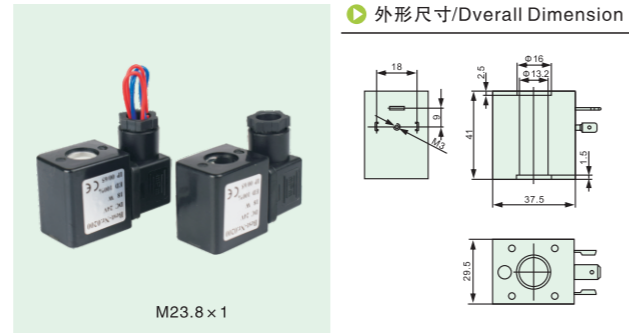

▶ 产品特性/Product characteristics

- 1、本企业标准气缸；
- 2、活塞密封采用异型双向密封结构，尺寸紧凑，有储油功能；
- 3、为拉杆式气缸，前后盖与铝管缸体用支柱连接，可靠性好；
- 4、与ISO15552标准气缸相比，通缸径SU系列气缸长度小；
- 5、气缸缓冲调解平稳；
- 6、多种规格的气缸及气缸安装附件可供客户选择使用；
- 7、选择耐高温密封材料，可保证气缸在150℃条件下正常工作。



▶ 型号含义/Model meaning

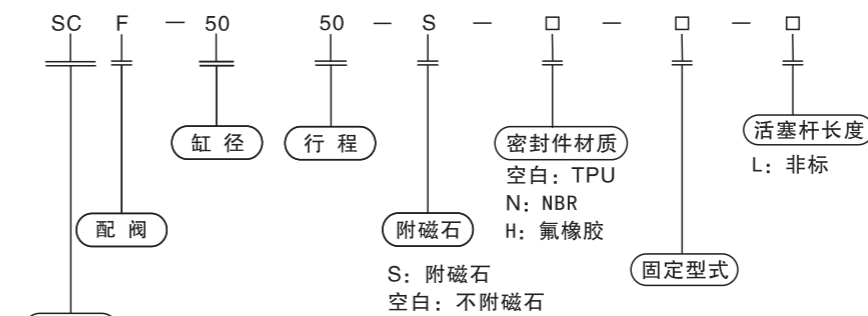

SC: 标准复动型
SCD: 双轴复动型
SCJ: 双轴复动行程可调型

▶ 外形尺寸/Overall Dimension

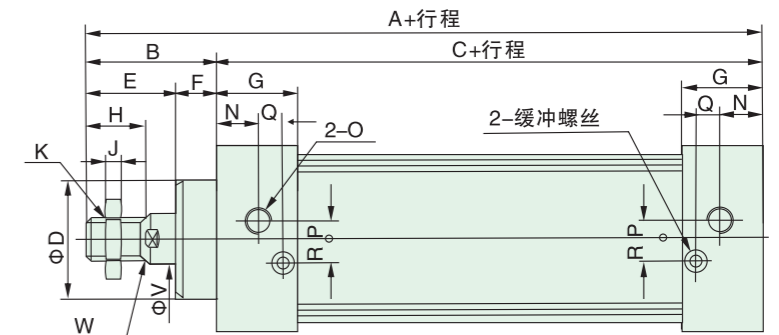
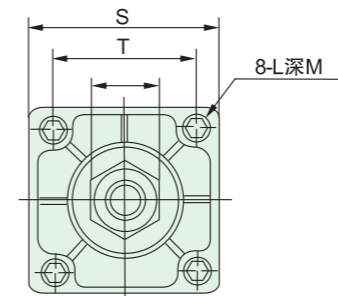

缸径/符号	A	B	C	D	E	F	G	H	I	J	K	L	M	N	O	P	Q	R	S	T	V	W
32	140	47	93	28	32	15	27.5	22	17	6	M10×1.25	M6×1	9.5	13.7	G1/8"	3.5	7.5	7	45	33	12	10
40	142	49	93	32	34	15	27.5	24	17	7	M12×1.25	M6×1	9.5	13.5	G1/4"	6	8.2	9	50	37	16	14
50	150	57	93	38	42	15	27.5	32	23	8	M16×1.5	M6×1	9.5	13.5	G1/4"	8.5	8.2	9	62	47	20	17
63	153	57	96	38	42	15	27.5	32	23	8	M16×1.5	M8×1.25	9.5	13.5	G3/8"	7	8.2	8.5	75	56	20	17
80	182	75	108	47	54	21	33	40	26	10	M20×1.5	M10×1.5	11.5	16.5	G3/8"	10	9.5	14	94	70	25	22
100	189	75	114	47	54	21	33	40	26	10	M20×1.5	M10×1.5	11.5	16.5	G1/2"	11	9.5	14	112	84	25	22
125	246	101	145	57	69	32	40	54	39	11	M27×2	M12×1.75	20	20	G1/2"	-	-	-	140	110	32	27
160	315	135	180	65	80	36	50	60	52	14	M36×2	M16×2	20	25	G3/4"	-	-	-	180	140	40	36
200	334	149	185	80	80	48	50	60	52	14	M36×2	M16×2	35	25	G3/4"	-	-	-	220	175	50	46

固定型式

固定型式	适用系列	备注
空白	SC,SCD,SCJ	
LB	SC,SCD,SCJ	
FA	SC,SCD,SCJ	
FB		
CA	SC	
CB		
TC	SC,SCD,SCJ	与TF配套使用